



Scandic Diesel Services Inc.  
*"It's smooth sailing from here"*

**DAIHATSU**

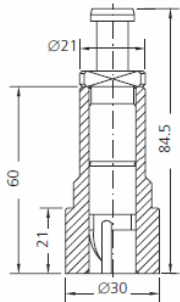

Fig.1

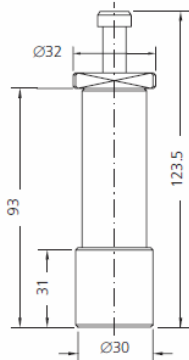

Fig.2

PUMP ELEMENTS SUITABLE TO:					DAIHATSU		
DRW.	ENGINE TYPE	SDS TYPE	SDS No.	ORIGINAL REFERENCE	TECHNICAL DATA		NOTES
					Ø	HELIX DIRECT.	
1	DS22D	CKX-P 040	1 26 14 0009	9N1 140101-0120	15	LH	C113670040Z
1	DS22D	CKX-P 041	1 26 14 0010	Z37 140151-6120	16	LH	C113670050Z
2	PS26D	CKX-P 049	1 12 14 0014	2-7A1 142101-2620	16	LH	C266402200Z
2	PSNTC-26D PS26D	CKX-P 050	1 12 14 0015	C15 142101-2420	17	LH	C266402210Z
2	DS22	CKX-P 055	1 12 14 0020	2-7A 141101-2220	16	LH	E226404190Z
2	PS26D	CKX-P 060	1 12 14 0025	C78 142101-3720	17	LH	C103600570Z

Scandic Diesel Services Inc.  
 6360 Notre Dame East  
 Montreal, Quebec  
 H1N 2E1, Canada

Phone +1 514 228 1299  
 Telefax +1 514 256 8237  
 24 hours +1 514 566 1553  
 Email sales@scandiserv.com

[www.scandiserv.com](http://www.scandiserv.com)

Scandic Diesel Services © 2009 - 2011  
 All rights reserved



**DAIHATSU**

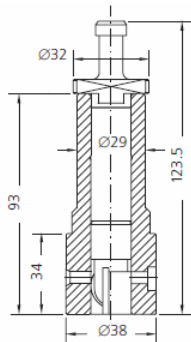

Fig.1

PUMP ELEMENTS SUITABLE TO:					DAIHATSU		
DRW.	ENGINE TYPE	SDS TYPE	SDS No.	ORIGINAL REFERENCE	TECHNICAL DATA		NOTES
					Ø	HELIX DIRECT.	
1	DS18A	CKX-P 170	1 14 14 0060	1424	16	LH	E186452030Z
1	DS22	CKX-P 073	1 14 14 0018	C25 141170-0020	16	LH	E226202190Z
1	DS22	CKX-P 074	1 14 14 0020	C26 141170-0120	17	LH	E226202200Z
1	DS22	CKX-P 075	1 14 14 0021	C27 141170-0220	16	LH	E266402210Z
1	PS26H	CKX-P 079	1 14 14 0032	C40 141170-1220	17	LH	C266402770Z
1	PS26H	CKX-P 076	1 14 14 0044	C43 141170-1520	18	LH	C266402810Z
1	PS26	CKX-P 080	1 14 14 0045	C45 141170-1720	20	LH	E266402040Z
1	PS26H	CKX-P 082	1 14 14 0033	C85 141175-0120	18	LH	E266402780Z
1	PS26H	CKX-P 078	1 14 14 0030	C86 141175-0220	17	LH	C266402800Z
1	PS26H	CKX-P 083	1 14 14 0034	C88 141175-0320	16	LH	C266402760Z
1	PS26H	CKX-P 084	1 14 14 0035	C89 141175-0420	16	LH	C266402790Z



**DAIHATSU**

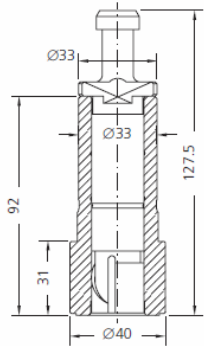

Fig.1

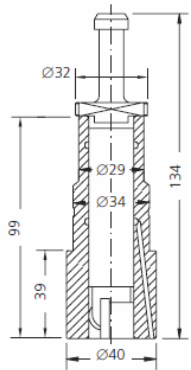

Fig.2

**PUMP ELEMENTS SUITABLE TO:**

**DAIHATSU**

DRW.	ENGINE TYPE	SDS TYPE	SDS No.	ORIGINAL REFERENCE	TECHNICAL DATA		NOTES
					Ø	HELIX DIRECT.	
1	PS 26	CKX-P 096	1 14 14 0036	W36 141170-6620	20	LH	E266412040Z
1	DS22A	CKX-P 101	1 14 14 0041	M20	20	LH	E266402050Z
1	DS26A	CKX-P 105	1 14 14 0043	W95 141175-6520	22	LH	E286402050A
2	DL20	CKX-P 160	1 14 14 0050	C113 141175-1921	20	LH	E206202040Z
2	PL24	CKX-P 165	1 14 14 0055	C118 141175-1121	20	LH	E246402060A

Scandic Diesel Services Inc.  
 6360 Notre Dame East  
 Montreal, Quebec  
 H1N 2E1, Canada

Phone +1 514 228 1299  
 Telefax +1 514 256 8237  
 24 hours +1 514 566 1553  
 Email sales@scandiserv.com

[www.scandiserv.com](http://www.scandiserv.com)

Scandic Diesel Services © 2009 - 2011  
 All rights reserved



## DAIHATSU

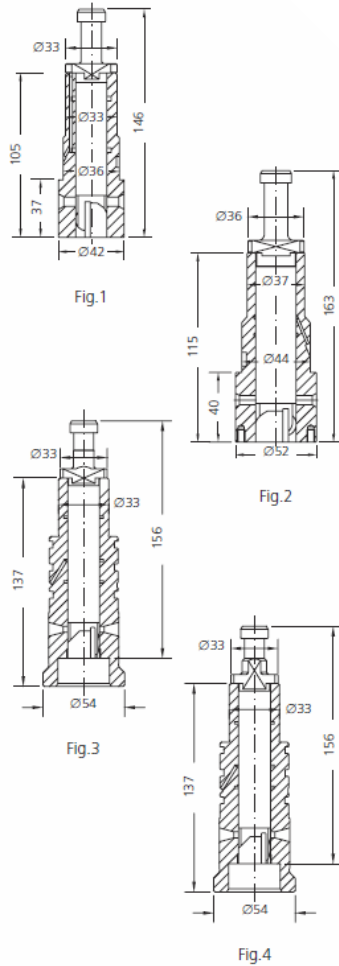

PUMP ELEMENTS SUITABLE TO:					DAIHATSU		
DRW.	ENGINE TYPE	SDS TYPE	SDS No.	ORIGINAL REFERENCE	TECHNICAL DATA		NOTES
					Ø	HELIX DIRECT.	
1	DL26	CKX-P 185	1 14 14 0085	W103 141175-7320	20	LH	E266452030Z
1	DLB26	CKX-P 190	1 14 14 0090	W136 141175-7921	22	LH	E266452040Z
2	6PL24	CKX-P 156	1 26 14 0039	GD39 141171-1120	24	LH	E326402070Z
3	DL22	CKX-P 235	1 26 14 0105	WV2 141185-0120	20	RH	E226450140Z
4	DL22	CKX-P 240	1 26 14 0110	WV3 141185-0220	21	RH	E226450150Z

Scandic Diesel Services Inc.  
 6360 Notre Dame East  
 Montreal, Quebec  
 H1N 2E1, Canada

Phone +1 514 228 1299  
 Telefax +1 514 256 8237  
 24 hours +1 514 566 1553  
 Email sales@scandiserv.com

[www.scandiserv.com](http://www.scandiserv.com)

Scandic Diesel Services © 2009 - 2011  
 All rights reserved



## DAIHATSU

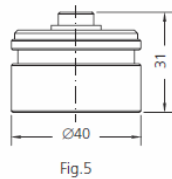
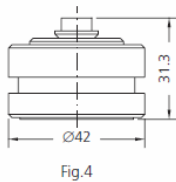
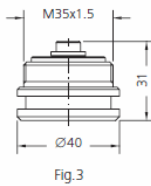
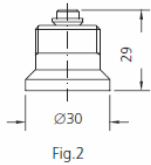
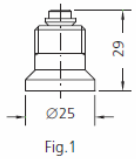

### DELIVERY VALVES SUITABLE TO:

### DAIHATSU

DRW.	ENGINE TYPE	SDS TYPE	SDS No.	ORIGINAL REFERENCE	TECHNICAL DATA	NOTES
					Ø	
1	PS20D	CKX-V 003	2 08 14 0004	10M	8	
2	PS26D	CKX-V 004	2 08 14 0005		8	C266402040Z
2	PS22D	CKX-V 005	2 09 14 0005	Z1 140110-2020	9	C113670120Z
3	DS26	CKX-V 010	2 10 14 0005	W1 141110-5320	10	C266402130Z
3	DS22-M	CKX-V 011	2 12 14 0010	C11 141140-0220	12	E226202040Z
4	DL26	CKX-V 015	2 10 14 0010	W28 141142-0020	10	E266452090Z
5	DL26-DLB26	CKX-V 020	2 12 14 0005	GD2 141110-6320	12	E326402220Z E326402221Z



## DAIHATSU

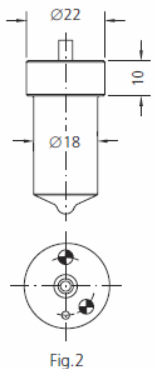
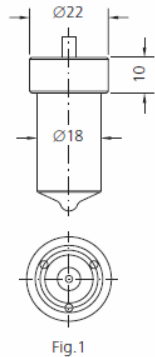

° = CROMATO - CHROMATED

### NOZZLE ELEMENTS SUITABLE TO:

### DAIHATSU

DRW.	ENGINE TYPE	SDS TYPE	SDS No.	ORIGINAL REFERENCE	SPRAY DATA	PRESS. STAGE	NOTES
1 <sup>c</sup>	PS-26D	L 130 T 328 NP 20	3 04 14 0005	DL 130 T 328 NP 20	8x0.32x130°	6x3.3	105018-0070
2	DL20	L 140 T 324.284 NP 32	3 04 14 0004	DL 140 T 324.284 NP 32	4x0.32x140° + 4x0.28x140°	6x3.5	105011-9790
1	6PS26D	L 140 T 328 NP 20	3 04 14 0007	DL 140 T 328 NP 20	8x0.32x140°	6x3.3	105018-0390 C299200420ZZ
2	DL20	L 145 TE 304.264 N 4	3 04 14 0035	DL 145 TE 304.264 N 4	4x0.30x145° + 4x0.26x145°	6x4.0	105018-0350 E206200880Z
2	DL20	L 145 T 324.284 N 4	3 04 14 0012	DL 145 TE 324.284 N 4	4x0.32x145° + 4x0.28x145°	6x3.2	105018-0290 E206200890ZZ
2	DS18	L 150 T 268 NP 22	3 04 14 0019	DL 150 T 268 NP 22	8x0.26x150°	6x4.5	105011-9340 E186210080Z
2	DS18A-DL19	L 150 T 268 NP 32	3 04 14 0017	DL 150 T 268 NP 32	8x0.26x150°	6x3.2	105011-9950
2	DS18	L 150 T 288 NP 22	3 04 14 0009	DL 150 T 288 NP 22	8x0.28x150°	6x4.0	105011-0630 E186200090Z
2	DS18A	L 150 T 308 NP 22	3 04 14 0022	DL 150 T 308 NP 22	8x0.30x150°	6x4.0	105011-9320 E186200110Z
1	DS22-PS26H	L 150 T 348 NP 20	3 04 14 0014	DL 150 T 348 NP 20	8x0.34x150°	6x3.2	105011-9270 C266200940Z
1	DS26-DS26A PS26	L 150 T 368 NP 20	3 04 14 0016	DL 150 T 368 NP 20	8x0.36x150°	6x3.2	105011-9710 C266200080Z
1	DS26-DS26A	L 150 T 388 NP 20	3 04 14 0015	DL 150 T 388 NP 20	8x0.38x150°	6x4.5	105011-9250 E266200100Z
2	DL24	L 145 TE 348 N 1	3 04 14 0060	DL 145 TE 348 N 1	8x0.34x145°	6x4.5	105018-0040 E226950603Z

Scandic Diesel Services Inc.  
 6360 Notre Dame East  
 Montreal, Quebec  
 H1N 2E1, Canada

Phone +1 514 228 1299  
 Telefax +1 514 256 8237  
 24 hours +1 514 566 1553  
 Email sales@scandiserv.com

[www.scandiserv.com](http://www.scandiserv.com)

Scandic Diesel Services © 2009 - 2011  
 All rights reserved



## DAIHATSU

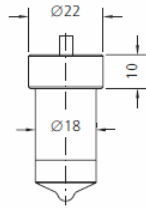

Fig.1

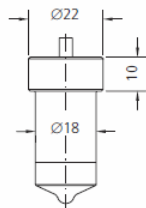

Fig.2

\* = RAFFREDDATO - COOLED  
 c = CROMATO - CHROMATED

### NOZZLE ELEMENTS SUITABLE TO:

### DAIHATSU

DRW.	ENGINE TYPE	SDS TYPE	SDS No.	ORIGINAL REFERENCE	SPRAY DATA	PRESS. STAGE	NOTES
*2	PS26D, PHTB26D	LF 130 TB 328 N 17	3 31 14 0024	DLF 130 TB 328 N 17	8x0.32x130°	6x3.2	105011-7240
*2 <sup>c</sup>	PL24	LF 140 TB 348 N 34	3 31 14 0029	DLF 140 TB 348 N 34	8x0.34x140°	6x4.5	E246200400Z
*1	PL24	LF 140 TE 368 N 1	3 31 14 0027	DLF 140 TE 368 N 1	8x0.36x140°	6x4.5	105011-7840 E246200090Z
*1 <sup>c</sup>	6DL20	LF 140 TB 324.284 N 34	3 31 14 0033	DLF 140 TB 324.284 N 34	4x0.32x140° + 4x0.28x140°	6x4.0	E206200100Z
*1 <sup>c</sup>	DL20	LF 145 TE 304.264 N 3	3 31 14 0036	DLF 145 TE 304.264 N 3	4x0.30x145° + 4x0.26x145°	6x3.2	105011-8360 E206200710Z
*1 <sup>c</sup>	DL22	LF 145 TE 308 N 1	3 31 14 0050	DLF 145 TE 308 N 1	8x0.30x145°	6x3.8	105011-7930 E226950060Z
*1 <sup>c</sup>	DL20	LF 145 TE 324.284 N 3 C	3 31 14 0037	DLF 145 TE 324.284 N 3 C	4x0.32x145° + 4x0.28x145°	6x3.8	105011-8200 E206200700Z
*1 <sup>c</sup>	DL22	LF 145 TE 328 N 3	3 31 14 0040	DLF 145 TE 328 N 3	8x0.32x145°	6x3.8	105011-8110 E226950482Z
*1 <sup>c</sup>	DL26	LF 145 TE 368 N 4 C	3 31 14 0039	DLF 145 TE 368 N 4 C	8x0.36x145°	6x3.8	105011-8180 E266250090ZZ
*1 <sup>c</sup>	DL26	LF 145 TE 428 N 4	3 31 14 0042	DLF 145 TE 428 N 4	8x0.42x145°	6x4.5	105011-8210 E266250510ZZ
*1 <sup>c</sup>	DL26	LF 145 TE 448 N 4	3 31 14 0043	DLF 145 TE 448 N 4	8x0.44x145°	6x4.5	105011-8300 E266250550ZZ
*1	DL19-DS19A	LF 150 TB 248 N 28	3 31 14 0008	DLF 150 TB 248 N 28	8x0.24x150°	6x3.2	105011-7900 E186250200Z
*2 <sup>c</sup>	DL19	LF 150 TB 268 N 28	3 31 14 0013	DLF 150 TB 268 N 28	8x0.26x150°	6x4.0	105011-7680 E186210250Z
*2	6PSHTB-26H 6PSHTC-26D/DS22	LF 150 TB 348 N 17	3 31 14 0025	DLF 150 TB 348 N 17	8x0.34x150°	6x3.8	105011-7260
*1	DS26A-PS26	LF 150 TB 368 N 27	3 31 14 0014	DLF 150 TB 368 N 27	8x0.36x150°	6x3.8	105011-7740 C266200090A

Scandic Diesel Services Inc.  
 6360 Notre Dame East  
 Montreal, Quebec  
 H1N 2E1, Canada

Phone +1 514 228 1299  
 Telefax +1 514 256 8237  
 24 hours +1 514 566 1553  
 Email sales@scandiserv.com

[www.scandiserv.com](http://www.scandiserv.com)

Scandic Diesel Services © 2009 - 2011  
 All rights reserved



## DAIHATSU

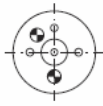
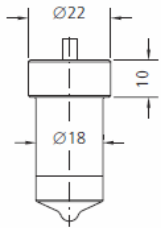

Fig.1

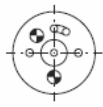
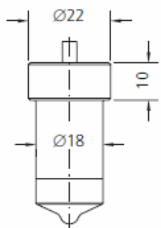

Fig.2

### NOZZLE ELEMENTS SUITABLE TO:

### DAIHATSU

DRW.	ENGINE TYPE	SDS TYPE	SDS No.	ORIGINAL REFERENCE	SPRAY DATA	PRESS. STAGE	NOTES
*1	PS22-PSTB22	LF 160 TB 306 N 8	3 31 14 0030	DLF 160 TB 306 N 8	6x0.30x160°	6x3.2	105011-6640
*1	DS22	LF 160 TB 328 N 17	3 31 14 0032	DLF 160 TB 328 N 17	8x0.32x160°	6x3.2	105011-7580 E226200080Z
*2	DS26-DS26H	LF 150 TB 388 N 17	3 31 14 0026	DLF 150 TB 388 N 17	8x0.38x150°	6x3.2	105011-7250
*1 <sup>c</sup>	DK 20	LF 140 TE 2610 N6C	3 31 14 0034	DLF 140 TE 2610 N6C	10x0,26x140°	6x4,5	105011-8450/51 E206250260AZ
*1 <sup>c</sup>	DK 20	LF 140 TE 2810 N6C	3 31 14 0035	DLF 140 TE 2810 N6C	10x0,28x140°	6x3,2	105011-8460/61 E206250290AZ
*1 <sup>c</sup>	DK 20	LF 140 TE 3010 N3C	3 31 14 0045	DLF 140 TE 3010 N3C	10x0,30x140°	6x3,2	105011-8470/71

\* = RAFFREDDATO - COOLED  
 c = CROMATO - CHROMATED

Scandic Diesel Services Inc.  
 6360 Notre Dame East  
 Montreal, Quebec  
 H1N 2E1, Canada

Phone +1 514 228 1299  
 Telefax +1 514 256 8237  
 24 hours +1 514 566 1553  
 Email sales@scandiserv.com

[www.scandiserv.com](http://www.scandiserv.com)

Scandic Diesel Services © 2009 - 2011  
 All rights reserved



Scandic Diesel Services Inc.  
*"It's smooth sailing from here"*

**DAIHATSU**

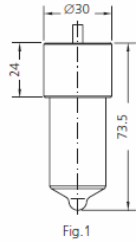

Fig.1

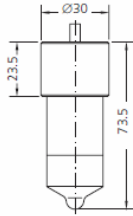

Fig.2

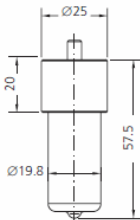

Fig.3

NOZZLE ELEMENTS SUITABLE TO:				DAIHATSU			
DRW.	ENGINE TYPE	SDS TYPE	SDS No.	ORIGINAL REFERENCE	SPRAY DATA	PRESS. STAGE	NOTES
1	DS28	L 150 U 408 NP 9 A	3 05 14 0005	DL 150 U 408 NP 9 A	8x0.40x150°	8x5.0	105012-0540 E286200210Z
1	DS28	L 150 U 428 NP 9	3 05 14 0010	DL 150 U 428 NP 9	8x0.42x150°	8x4.7	105012-0570 E286200100A
*2	8DMK32	LF 140 UB 559 N 27	3 33 14 0010	DLF 140 UB 559 N 27	9x0.55x140°	8x5.0	105012-6140
*2	DL32	LF 150 UB 479 N 9	3 33 14 0015	DLF 150 UB 479 N 9	9x0.47x150°	8x5.5	105012-5630
*3 <sup>C</sup>	DL28 DL6-2B - DL26-2B	LF 145 TU 458 N 6 C	3 32 14 0020	DLF 145 TU 458 N 6 C	8x0.45x145°	6x3.5	105016-6490 E286250590Z

\* = RAFFREDDATO - COOLED  
 C = CROMATO - CHROMATED

Scandic Diesel Services Inc.  
 6360 Notre Dame East  
 Montreal, Quebec  
 H1N 2E1, Canada

Phone +1 514 228 1299  
 Telefax +1 514 256 8237  
 24 hours +1 514 566 1553  
 Email sales@scandiserv.com

[www.scandiserv.com](http://www.scandiserv.com)

Scandic Diesel Services © 2009 - 2011  
 All rights reserved