



Scandic Diesel Services Inc.  
*"It's smooth sailing from here"*

## ECHEVARIA

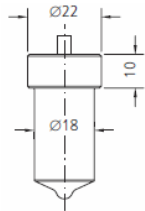

Fig.1

NOZZLE ELEMENTS SUITABLE TO:				ECHEVARIA			
DRW.	ENGINE TYPE	SDS TYPE	SDS No.	ORIGINAL REFERENCE	SPRAY DATA	PRESS. STAGE	NOTES
1	MS22 22-2,3,5	L 130 T 204	3 04 02 0350	DL 130 T 204	8x0.25x130°	6x3.0	0 433 300 101 110-275 PS
1	MS24 24-4,5,6	L 130 T 1170	3 04 02 0785	DL 130 T 1170	8x0.285x130°	7x3.5	0 433 300 298 260-430 PS
1	3M21	L 130 T 204	3 04 02 0350	DL 130 T 204	8x0.25x130°	6x3.0	0 433 300 101 135 PS
1	3M22	L 130 T 204	3 04 02 0350	DL 130 T 204	8x0.25x130°	6x3.0	0 433 300 101 150 PS
1	4M21	L 130 T 204	3 04 02 0350	DL 130 T 204	8x0.25x130°	6x3.0	0 433 300 101 200 PS

Scandic Diesel Services Inc.  
 6360 Notre Dame East  
 Montreal, Quebec  
 H1N 2E1, Canada

Phone +1 514 228 1299  
 Telefax +1 514 256 8237  
 24 hours +1 514 566 1553  
 Email sales@scandiserv.com

[www.scandiserv.com](http://www.scandiserv.com)

Scandic Diesel Services © 2009 - 2011  
 All rights reserved