



## FRICHS – VOLUND A/S

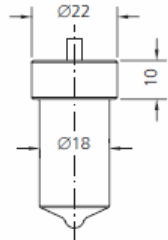

Fig.1

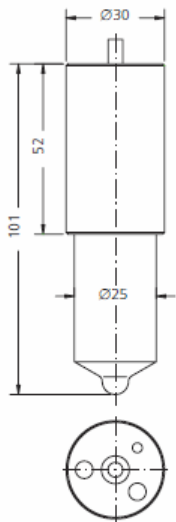

Fig.2

### NOZZLE ELEMENTS SUITABLE TO:

### FRICHS - VOLUND A/S

| DRW. | ENGINE TYPE        | SDS TYPE    | SDS No.      | ORIGINAL REFERENCE | SPRAY DATA  | PRESS. STAGE | NOTES                      |
|------|--------------------|-------------|--------------|--------------------|-------------|--------------|----------------------------|
| 1    | DM 330, DM 430     | L 145 T 769 | 3 04 02 0505 | DL 145 T 769       | 6x0.30x145° | 6x3.0        | 0 433 300 156              |
| 1    | DM 530, DM 630     | L 145 T 991 | 3 04 02 0625 | DL 145 T 991       | 8x0.25x145° | 6x3.0        | 0 433 300 160              |
| 2    | DMT, DMTK 530, 630 | LLA 145 U 2 | 3 06 02 0305 | DLLA 145 U 2       | 7x0.35x145° | 8x4.0        | 0 433 421 001<br>CHROMATED |
|      |                    |             |              |                    |             |              |                            |
|      |                    |             |              |                    |             |              |                            |