



GENERAL ELECTRIC

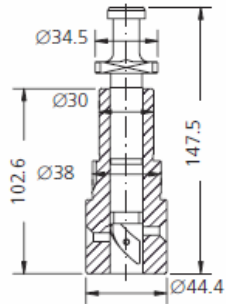

Fig.1

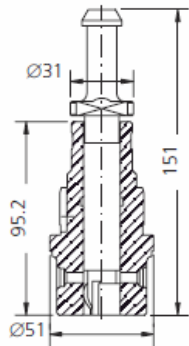

Fig.2

PUMP ELEMENTS SUITABLE TO:					GENERAL ELECTRIC		
DRW.	ENGINE TYPE	SDS TYPE	SDS No.	ORIGINAL REFERENCE	TECHNICAL DATA		NOTES
					Ø	HELIX DIRECT.	
1		CBX-P 100	1 14 18 0085	10-375427	17	LH	GE 132x1293/1
1		CBX-P 120	1 14 18 0105	10-519368	18	LH	GE 132x1541
2		CBR-P 220	1 14 03 0045	36/221C	18	LH	GE 132x1709



GENERAL ELECTRIC

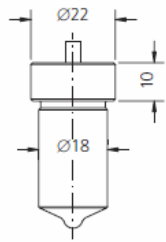

Fig.1

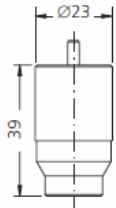

Fig.2

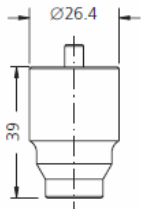

Fig.3

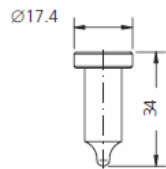

Fig.4

NOZZLE ELEMENTS SUITABLE TO:

GENERAL ELECTRIC

DRW.	ENGINE TYPE	SDS TYPE	SDS No.	ORIGINAL REFERENCE	SPRAY DATA	PRESS. STAGE	NOTES
1	ALCO 450-500	L 145 TM 827-6	3 04 01 0560	GE 123x1053	9x0.375x145°	7x4.0	
1	9"x10" 1/2	L 150 TM 832-6	3 04 01 0575	GE 123x1065-1	10x0.40x150°	7x4.75	
1	7 FOL - 7FDL	L 150 T 40 L 814 P 4	3 04 03 0465	GE 123x1098	10x0.40x150°	7x4.5	
1	9"x10" 1/2	L 157 TM 837-6	3 04 01 0583	GE 123x1074.2	10x0.40x157°	7x4.75	
2		CBX-D 030	3 19 18 0010	GE 123x1033	Ø 1,9	6,35x3.5	10-83547-2
3		CBX-D 035	3 19 18 0015	GE 123x1052	Ø 2,35	7,15x4.85	10-328310
4		CBX-D 047	3 11 18 0027	GE 123x1082	10x0.35x150°	-	10-375292-10
4		CBX-D 050	3 11 18 0030	GE 123x1053-1	10x0.40x150°	-	10-519262-1