

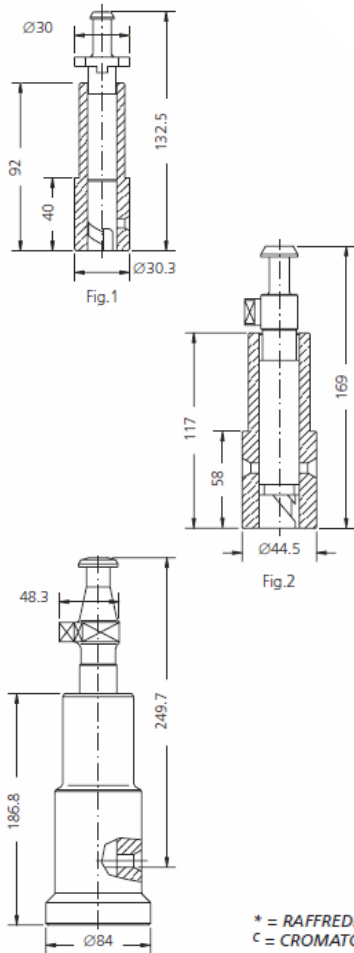

MIRRLEES



* = RAFFREDDATO - COOLED
 C = CROMATO - CHROMATED

Fig.3

Scandic Diesel Services Inc.
 6360 Notre Dame East
 Montreal, Quebec
 H1N 2E1, Canada

Phone +1 514 228 1299
 Telefax +1 514 256 8237
 24 hours +1 514 566 1553
 Email sales@scandiserv.com

PUMP ELEMENTS SUITABLE TO:					MIRRLEES		
DRW.	ENGINE TYPE	SDS TYPE	SDS No.	ORIGINAL REFERENCE	TECHNICAL DATA		NOTES
					Ø	HELIX DIRECT.	
1	J, JL	CBR-P 083	1 12 03 0046	3/298G	16	LH	BELOW AND ABOVE 675 rpm
1	J	CBR-P 083	1 12 03 0046	3/298G	16	LH	800 TO 1000 rpm
1	JS, JLS	CBR-P 083	1 12 03 0046	3/298G	16	LH	BELOW 750 rpm
1	JS	CBR-P 083	1 12 03 0046	3/298G	16	LH	800 TO 1000 rpm
1	JSS, JLSS	CBR-P 071	1 12 03 0097	3/298K	18	LH	BELOW 750 rpm
1	JSS	CBR-P 071	1 12 03 0097	3/298K	18	LH	800 TO 1000 rpm
1	TLS	CBR-P 083	1 12 03 0046	3/298G	16	LH	500 TO 650 rpm
1	RP	CBR-P 083	1 12 03 0046	3/298G	16	LH	700 rpm
1	RS, RSS	CBR-P 071	1 12 03 0097	3/298K	18	LH	750 rpm
2	F, FS, FP	CBR-P 130	1 16 03 0005	21/19C	18	LH	300 TO 600 rpm
2	FSS, FSCP	CBR-P 131	1 16 03 0010	21/19D	20	LH	300 TO 600 rpm
2	FSCP	CBR-P 131	1 16 03 0010	21/19D	20	LH	TOWNGAS
2	HF	CBR-P 131	1 16 03 0010	21/19D	20	LH	
3	ALSS	CBR-P 300	1 17 03 0005	32/36D	30	LH	BELOW 250 rpm
3	ALSS	CBR-P 300	1 17 03 0005	32/36D	30	LH	250 TO 300 rpm

www.scandiserv.com

Scandic Diesel Services © 2009 - 2011
 All rights reserved



Scandic Diesel Services Inc.
"It's smooth sailing from here"

MIRRLEES

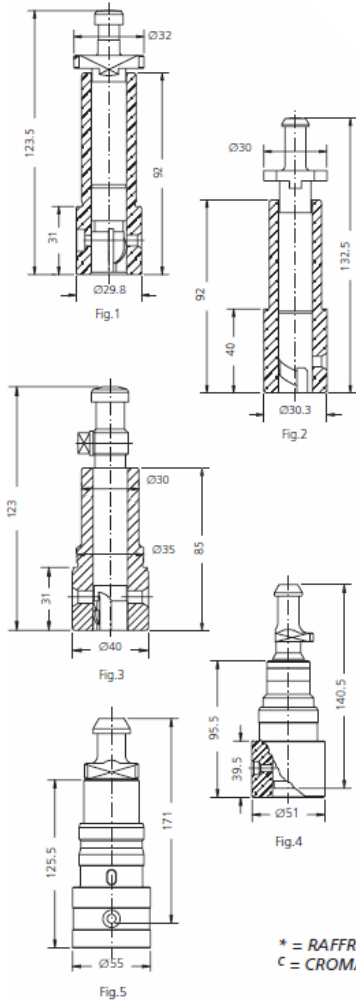

* = RAFFREDDATO - COOLED
 C = CROMATO - CHROMATED

PUMP ELEMENTS SUITABLE TO:

MIRRLEES

DRW.	ENGINE TYPE	SDS TYPE	SDS No.	ORIGINAL REFERENCE	TECHNICAL DATA		NOTES
					Ø	HELIX DIRECT.	
1	EB, EH, ER, ES, EV	CCV-P 030	1 12 04 0150	7022-132 Bx62	16	RH	MIRRLEES STAMFORD
1	EBS, ERS, ESS, EVS	CCV-P 030	1 12 04 0150	7022-132 Bx62	16	RH	MIRRLEES STAMFORD
1	ERDF, ESDF, EVDF	CCV-P 030	1 12 04 0150	7022-132 Bx62	16	RH	MIRRLEES STAMFORD
2	ERDFS, ESDFS, EVDFS	CBR-P 073	1 12 03 0105	3/416K	18	RH	MIRRLEES STAMFORD
2	ECSL, ESSL, EDSL, EWSL	CBR-P 073	1 12 03 0105	3/416K	18	RH	MIRRLEES STAMFORD
2	EXSL, EYSL, EVSL	CBR-P 073	1 12 03 0105	3/416K	18	RH	MIRRLEES STAMFORD
3	4 VALVE HEAD ELS (MKII)	CBR-P 104	1 14 03 0054	6/441C	18	RH	MIRRLEES STAMFORD
3		CBR-P 107	1 14 03 0057	6/513E	20	RH	
4	EVSL (MKII)	CBR-P 208	1 14 03 0033	36/189E	20	RH	
5	MKII	CBR-P 225	1 42 03 0025	37/103G	24	LH	

Scandic Diesel Services Inc.
 6360 Notre Dame East
 Montreal, Quebec
 H1N 2E1, Canada

Phone +1 514 228 1299
 Telefax +1 514 256 8237
 24 hours +1 514 566 1553
 Email sales@scandiserv.com

www.scandiserv.com

Scandic Diesel Services © 2009 - 2011
 All rights reserved



MIRRELES

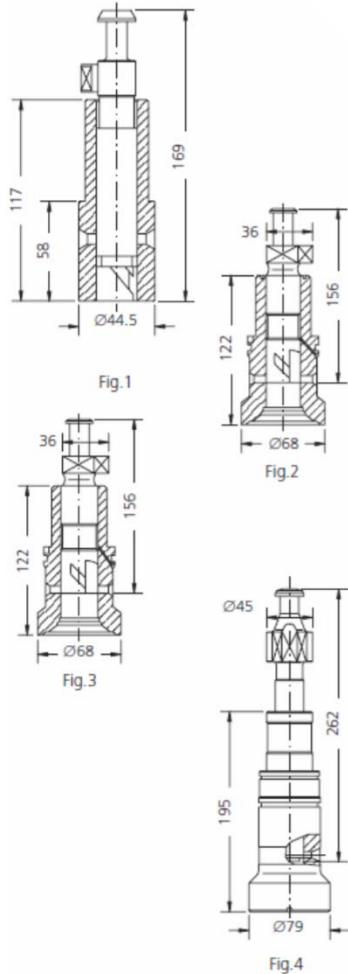

PUMP ELEMENTS SUITABLE TO:					MIRRELES		
DRW.	ENGINE TYPE	SDS TYPE	SDS No.	ORIGINAL REFERENCE	TECHNICAL DATA		NOTES
					Ø	HELIX DIRECT.	
1	HF	CBR-P 131	1 16 03 0010	21/19D	20	LH	
1	K SERIE I	CBR-P 131	1 16 03 0010	21/19D	20	LH	ASPIRATED
1	HL	CBR-P 133	1 16 03 0015	21/19F	24	LH	
1	K SERIE I	CBR-P 134	1 16 03 0016	21/194F	24	LH	TURBO CHARGED GAS/HEAVY FUEL
2	K MAJOR MK I	CBR-P 253	1 17 03 0013	22/141	30	LH	LIGHT FUEL
3	K MAJOR MK I	CBR-P 251	1 17 03 0011	22/109	28	LH	UP TO 220
3	K MAJOR MK I	CBR-P 251	1 17 03 0011	22/109	28	LH	LIGHT FUEL
2	K MAJOR MK I	CBR-P 253	1 17 03 0013	22/141	30	LH	HEAVY FUEL
4	K MAJOR MK III	CBR-P 280	1 17 03 0015	34/33F	28	LH	
4	K MAJOR MK III	CBR-P 285	1 17 03 0030	34/73G	30	LH	
4	K MAJOR	CBR-P 281 H	1 17 03 0020	34/56F	28	LH	

Scandic Diesel Services Inc.
 6360 Notre Dame East
 Montreal, Quebec
 H1N 2E1, Canada

Phone +1 514 228 1299
 Telefax +1 514 256 8237
 24 hours +1 514 566 1553
 Email sales@scandiserv.com

www.scandiserv.com

Scandic Diesel Services © 2009 - 2011
 All rights reserved



MIRRLEES

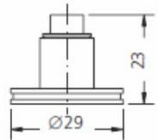

Fig.1

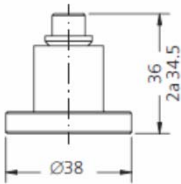

Fig.2

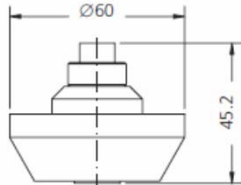

Fig.3

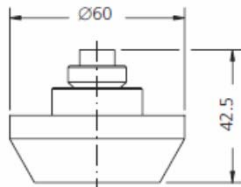

Fig.4

Scandic Diesel Services Inc.
 6360 Notre Dame East
 Montreal, Quebec
 H1N 2E1, Canada

Phone +1 514 228 1299
 Telefax +1 514 256 8237
 24 hours +1 514 566 1553
 Email sales@scandiserv.com

www.scandiserv.com

Scandic Diesel Services © 2009 - 2011
 All rights reserved

DELIVERY VALVES SUITABLE TO:					MIRRLEES	
DRW.	ENGINE TYPE	SDS TYPE	SDS No.	ORIGINAL REFERENCE	TECHNICAL DATA	NOTES
					Ø	
1	ERDFS, ESDFS EVDFS	CBR-V 020	2 26 03 0021	25/52	8	
1	ECSL, ESSL, ETS ETSL, EVSL	CBR-V 020	2 26 03 0021	25/52	8	
1	EXSL, EYSL EZSL	CBR-V 020	2 26 03 0021	25/52	8	
1	J, JL, JS, JLS	CBR-V 020	2 26 03 0021	25/52	8	
1	JSS, JLSS	CBR-V 020	2 26 03 0021	25/52	8	
1	JVST12, JVSST 12	CBR-V 020	2 26 03 0021	25/52	8	
1	R, RP, RS, RSS, RSCP	CBR-V 020	2 26 03 0021	25/52	8	
1	TP-TP(T), TLS	CBR-V 020	2 26 03 0021	25/52	8	
2a	K SERIES I	CBR-V 048	2 15 03 0008	6/118	12	
2	HF	CBR-V 072	2 26 03 0010	21/125D	12	
2	K SERIES I	CBR-V 072	2 26 03 0010	21/125D	12	
2	F, FP, FS, FSS, FSCP	CBR-V 072	2 26 03 0010	21/125D	12	
3	ALSS	CBR-V 300	2 18 03 0100		16	FOR PUMP 32/99 D
4	ALSS	CBR-V 301	2 18 03 0101	32/47	16	FOR PUMP 32/89 D



MIRRLEES

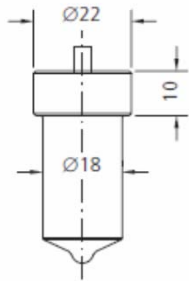

Fig.1

NOZZLE ELEMENTS SUITABLE TO:					MIRRLEES		
DRW.	ENGINE TYPE	SDS TYPE	SDS No.	ORIGINAL REFERENCE	SPRAY DATA	PRESS. STAGE	NOTES
1	TL	L 130 T 30 F 372 P 3	3 04 03 0290	H 130 T 30 F 372 P 3	6x0.30x130°	6x3.0	500÷650 rpm
1	TL	L 130 T 30 F 372 P 3	3 04 03 0290	H 130 T 30 F 372 P 3	6x0.30x130°	6x3.0	VARIABLE SPEED
1	RP	L 150 T 35 EP 6	3 04 03 0355	HL 150 T 35 EP 6	5x0.35x150°	6x3.0	600 rpm
1	EB, EH, ER, ES, EV	L 160 T 33 FP 6	3 04 03 0425	H 160 T 33 FP 6	6x0.33x160°	6x3.0	MIRRLEES STAMFORD
1	EBS, ERS, ESS EVS	L 160 T 40 F 576	3 04 03 0445	H 160 T 40 F 576	6x0.40x160°	6x3.5	MIRRLEES STAMFORD
1	ERDF, ESDL, EVDF	L 160 T 33 FP 6	3 04 03 0425	H 160 T 33 FP 6	6x0.33x160°	6x3.0	MIRRLEES STAMFORD
1	ERDFS, ESDFS, EVDFS	L 160 T 40 F 576	3 04 03 0445	H 160 T 40 F 576	6x0.40x160°	6x3.5	MIRRLEES STAMFORD
1	ECSL, ESSL, ETS, ETSL, EWSL	L 160 T 45 F 464 P 4	3 04 03 0460	H 160 T 45 F 464 P 4	6x0.45x160°	6x3.5	MIRRLEES STAMFORD
1	EXSL, EYSL, EWSL, EZSL	L 160 T 45 F 464 P 4	3 04 03 0460	H 160 T 45 F 464 P 4	6x0.45x160°	6x3.5	MIRRLEES STAMFORD
1	ELS (MKII) 4 VALVE HEAD	L 150 T 38 H 464 P 4	3 04 03 0397	H 150 T 38 H 464 P 4	8x0.38x150°	6x3.5	MIRRLEES STAMFORD
1	RP	L 60 T 55 B 453 P 5	3 04 03 0216	H 60 T 55 B 453 P 5	2x0.55x60°	6x3.0	MIRRLEES STAMFORD
1	NATIONAL	L 120 T 35 HP 3	3 04 03 0269	H 120 T 35 HP 3	8x0.35x120°	6x3.5	MIRRLEES NATIONAL



MIRRLEES

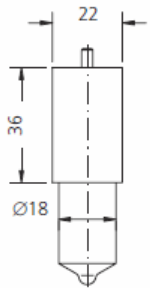

Fig.1

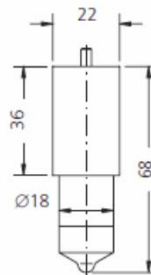

Fig.2

NOZZLE ELEMENTS SUITABLE TO:				MIRRLEES			
DRW.	ENGINE TYPE	SDS TYPE	SDS No.	ORIGINAL REFERENCE	SPRAY DATA	PRESS. STAGE	NOTES
1	J-JL	LL 150 T 30 F 200 P 4	3 06 03 0043	HL 150 T 30 F 200 P 4	6x0.30x150°	8x5.0	BELOW 675 rpm
1	J-JL	LL 150 T 35 F 200 P 4	3 06 03 0039	HL 150 T 35 F 200 P 4	6x0.35x150°	8x5.0	ABOVE 675 rpm
1	J	LL 150 T 35 F 200 P 4	3 06 03 0039	HL 150 T 35 F 200 P 4	6x0.35x150°	8x5.0	800÷1000 rpm
1	J-JL	LL 150 T 35 F 200 P 4	3 06 03 0039	HL 150 T 35 F 200 P 4	6x0.35x150°	8x5.0	ABOVE 675 rpm VARIABLE SPEED
1	JS-JLS	LL 150 T 35 H 200 P 4	3 06 03 0040	HL 150 T 35 H 200 P 4	8x0.35x150°	8x5.0	BELOW 750 rpm
1	JS	LL 150 T 42 K 200 P 4	3 06 03 0020	HL 150 T 42 K 200 P 4	9x0.42x150°	8x5.0	800÷1000 rpm
1	JS-JLS	LL 150 T 35 H 200 P 4	3 06 03 0040	HL 150 T 35 H 200 P 4	8x0.35x150°	8x5.0	VARIABLE SPEED BELOW 675 rpm
1	JS	LL 150 T 42 K 200 P 4	3 06 03 0020	HL 150 T 42 K 200 P 4	9x0.42x150°	8x5.0	VARIABLE SPEED ABOVE 675 rpm
1	JSS, JLSS	LL 150 T 42 K 200 P 4	3 06 03 0020	HL 150 T 42 K 200 P 4	9x0.42x150°	8x5.0	BELOW 750 rpm
1	JSS	LL 150 T 42 K 200 P 4	3 06 03 0020	HL 150 T 42 K 200 P 4	9x0.42x150°	8x5.0	800÷1000 rpm
1	JSS, JLSS	LL 150 T 42 K 200 P 4	3 06 03 0020	HL 150 T 42 K 200 P 4	9x0.42x150°	8x5.0	VARIABLE SPEED
1	JVST12	LL 150 T 42 K 200 P 4	3 06 03 0020	HL 150 T 42 K 200 P 4	9x0.42x150°	8x5.0	1600 BHP
1	JVSST12	LL 150 T 42 K 200 P 4	3 06 03 0020	HL 150 T 42 K 200 P 4	9x0.42x150°	8x5.0	2000 BHP
*2	MB275-MB	LL 155 T 46 K 880 P 4	3 30 03 0070	HL 155 T 46 K 880 P 4	9x0.46x155°	7x4.5	HEAVY FUEL

* = RAFFREDDATO - COOLED
 C = CROMATO - CHROMATED

Scandic Diesel Services Inc.
 6360 Notre Dame East
 Montreal, Quebec
 H1N 2E1, Canada

Phone +1 514 228 1299
 Telefax +1 514 256 8237
 24 hours +1 514 566 1553
 Email sales@scandiserv.com

www.scandiserv.com

Scandic Diesel Services © 2009 - 2011
 All rights reserved



MIRRLEES

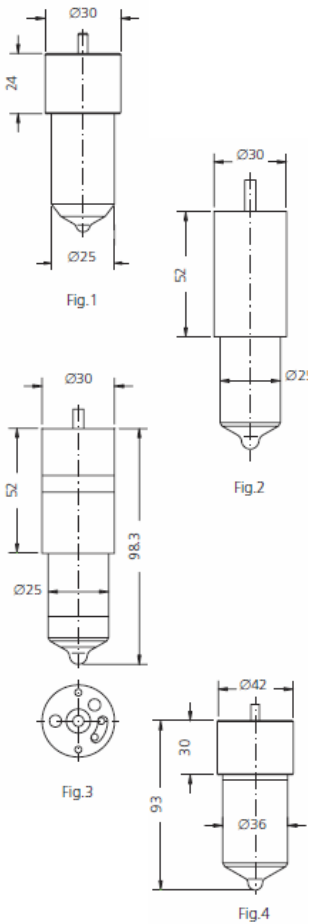

NOZZLE ELEMENTS SUITABLE TO:

MIRRLEES

DRW.	ENGINE TYPE	SDS TYPE	SDS No.	ORIGINAL REFERENCE	SPRAY DATA	PRESS. STAGE	NOTES
1	HF	L 140 U 45 F 353 P 5	3 05 03 0055	H 140 U 45 F 353 P 4	6x0.45x140°	8x4.5	
1	K SERIES I	L 135 U 45 G 353 P 5	3 05 03 0035	H 135 U 45 G 353 P 5	7x0.45x135°	8x5.0	ASPIRATED GAS OIL
1	K SERIES I	L 135 U 47 H 353 P 5	3 05 03 0040	H 135 U 47 H 353 P 5	8x0.47x135°	8x5.0	TURBO CHARGED GAS/HEAVY FUEL
1	K SERIES II	L 135 U 50 H 353 P 5	3 05 03 0043	H 135 U 50 H 353 P 5	8x0.50x135°	8x5.0	LIGHT FUEL
2	K MAJOR-MK I	LL 135 U 67 H 430 P 6	3 07 03 0015	HL 135 U 67 H 430 P 6	8x0.67x135°	10x6.25	LIGHT FUEL
*3	K MAJOR-MK I	LL 135 U 67 H 634 P 6	3 32 03 0020	HL 135 U 67 H 634 P 6	8x0.67x135°	10x6.25	HEAVY FUEL
2	K MAJOR-MK II	LL 135 U 67 H 430 P 6	3 07 03 0015	HL 135 U 67 H 430 P 6	8x0.67x135°	10x6.25	LIGHT FUEL
*3	K MAJOR-MK II	LL 135 U 67 H 634 P 6	3 32 03 0020	HL 135 U 67 H 634 P 6	8x0.67x135°	10x6.25	HEAVY FUEL
*3	K MAJOR	LL 135 U 67 H 634 P 6	3 32 03 0020	HL 135 U 67 H 634 P 6	8x0.67x135°	10x6.25	DUAL FUEL
*3	K MAJOR MK 1	LL 135 U 67 H 634 P 6	3 32 03 0020	HL 135 U 67 H 634 P 6	8x0.67x135°	10x6.25	HEAVY FUEL
4	ALSS	L 145 V 63 L 401 P 6	3 07 03 0100	H 145 V 63 L 401 P 6	10x0.63x145°	12x7.5	UPRATED
3	K MAJOR-MK	LL 135 U 67 H 820 P 6	3 07 03 0018	HL 135 U 67 H 820 P 6	8x0.67x135°	10x6.25	LIGHT FUEL
*3	K MAJOR-MK	LL 135 U 67 H 821 P 6	3 32 03 0021	HL 135 U 67 H 821 P 6	8x0.67x135°	10x6.25	HEAVY FUEL
*3	K	LL 155 U 50 H 821 P 3	3 32 03 0110	HL 155 U 50 H 821 P 3	9x0.50x155°	10x6.25	HEAVY FUEL

* = RAFFREDDATO - COOLED
 c = CROMATO - CHROMATED

Scandic Diesel Services Inc.
 6360 Notre Dame East
 Montreal, Quebec
 H1N 2E1, Canada

Phone +1 514 228 1299
 Telefax +1 514 256 8237
 24 hours +1 514 566 1553
 Email sales@scandiserv.com

www.scandiserv.com

Scandic Diesel Services © 2009 - 2011
 All rights reserved



Scandic Diesel Services Inc.
"It's smooth sailing from here"

MIRRLEES

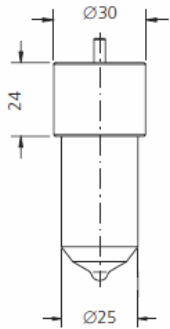

Fig.1

NOZZLE ELEMENTS SUITABLE TO:				MIRRLEES			
DRW.	ENGINE TYPE	SDS TYPE	SDS No.	ORIGINAL REFERENCE	SPRAY DATA	PRESS. STAGE	NOTES
1	B2 AUDM	L 140 U 40 H 353 P 4	3 05 03 0041	H 140 U 40 H 353 P 4	8x0.40x140°	8x5.0	BELOW 300 rpm
1	B2 AUDM	L 140 U 45 H 353 P 5	3 05 03 0065	H 140 U 45 H 353 P 5	8x0.45x140°	8x4.5	333 rpm
1	B4 A	L 140 U 40 H 353 P 4	3 05 03 0041	H 140 U 40 H 353 P 4	8x0.40x140°	8x5.0	BELOW 300 rpm
1	B4 A, B4 AU B4 AUP	L 140 U 45 H 353 P 5	3 05 03 0065	H 140 U 45 H 353 P 5	8x0.45x140°	8x5.0	333 rpm

Scandic Diesel Services Inc.
 6360 Notre Dame East
 Montreal, Quebec
 H1N 2E1, Canada

Phone +1 514 228 1299
 Telefax +1 514 256 8237
 24 hours +1 514 566 1553
 Email sales@scandiserv.com

www.scandiserv.com

Scandic Diesel Services © 2009 - 2011
 All rights reserved